

# GENERATIONS

*Investing in Our Future*

**G+GRACE**  
COMMUNITY FELLOWSHIP



# GENERATIONS

Investing in Our Future

Defining moments are dotted across the landscape of our church community. The truly defining moments of Grace Community Fellowship are not buildings made from human hands, but are made from the transformation of hearts changed by Jesus.

When I think of our *Generations Initiative*, I think of the future leaders in our church, in our business community, and in our local government. Entire generations have come up through the kids and youth ministries at GCF to become ministry leaders or staff members here! The next generation of Christ-following leaders are already in our high school today. In a few short

years, they will be the next wave of leaders making a spiritual impact in our church, in our community, and in our world.

## The *Generations Initiative* is:

*Investing* in the equipping of adults who are here now.

*Investing* in the people who are leaders today.

*Investing* in the leaders of tomorrow.

The *Generations Initiative* will raise funds over a three-year period, which will be invested in building space to develop future



generations who follow Jesus, impacting our community and the world with the Gospel. Our goal is to be able to finish the existing 8,000 square feet upstairs, and add an additional 2,500 square feet of space for a small auditorium with a covered playground underneath. This expansion will enable us to meet current needs, and will provide space for future ministry growth within our building and to our surrounding community.

*“Leaving a  
legacy of faith  
starts right now.”*

**In the fall of 2017 we will spend several weeks as a church prayerfully asking God how He would like each of us to invest in the future of Grace Community Fellowship.** I believe He will bless our church with the funds to complete this project and reach future generations that we currently would not have the space for. I hope that every individual and family at GCF will prayerfully and faithfully follow God’s leading on how to invest in the future of Grace through the *Generations Initiative*.

Even if the building we are meeting in today were to be torn down in 100 years, it doesn’t matter. What really matters is what happens in the lives of people who walk through the doors. It matters when a 5th grader prays to receive Jesus with their small

group leader. It matters when a 17-year old girl bows in silent prayer and asks Christ to come into her life. It matters when a 25-year-old young person gets up out of their seat and takes communion and quietly says, “Lord, I’m taking the next step.” It matters when a retired man takes a younger man to lunch and mentors him.

My hope for—and challenge to—our church is to be all-in for this initiative, because leaving a legacy of faith starts right now.



# DEFINING MOMENTS OF GRACE COMMUNITY FELLOWSHIP

**1981** GCF started a Chinese church in Eugene, and they are still going strong today



**1989** The current GCF property was purchased for \$165,000, and was raised 4 feet to get above the flood zone.



**1980** GCF is started with 29 families meeting in a living room

**1983** GCF financially supported a church plant in Roseburg, which now has over 1,500 members.



**2004** GCF doubled in size and needed more space. We are now meeting in that space





**2011** GCF increased the size of the auditorium by 60%



## Investing in Our Future

**2017** GCF launches an initiative to fund a 10,500 square foot expansion upstairs, for the purposes of discipleship and ministry. The *Generations Initiative* will increase opportunities for church ministries, as well as for other organizations in our community that might need space. We will continue to look for ways to maximize all of our spaces by using them in a variety of ways such as:

- Youth Ministry
- Large Group Bible Studies
- Community Gatherings (One-Hope, Every Child)
- Leader Trainings & Workshops
- Private Events
- Worship Nights
- Annual Women's Conference
- Financial Peace University
- Discipleship Training Institute
- NEXT & New Member Classes

LOVE

Fearlessly

# OUR PASSION IS SUMMED UP IN 4 WORDS:

*There is no fear in love.  
But perfect love drives out fear.*

**1 JOHN 4:18**

Our mission statement at Grace Community Fellowship—*Love people where they're at and help them follow Jesus*—is rooted in loving people, and to love people, we must have a place for them. A place where they feel welcomed, a place where they can become connected to others, a place where they can learn about Jesus and grow in their faith, a place where those who don't know Jesus will find Him and begin a new relationship with Him. The leaders of tomorrow are already here in our children's area, middle school, high school and young adults. Our most recent VBS program had to turn away many children due to our current space limitations, and our middle school kids are using re-purposed closet space and other less-than-ideal areas for small group discussions on Sunday morning. The *Generations Initiative* will allow us to expand our physical space to meet our growing ministry needs and impact future generations to make a difference for Christ in our church, community, and world.

SERVE

Selflessly

*Anyone who wants to be first must be  
the very last and the servant of all.*

**MARK 9:35**

At Grace Community Fellowship we strive to serve selflessly. We serve each other within our walls, and we serve our community and our world in a variety of ways. A welcoming, hospitable building provides us with opportunities within our walls to encourage and teach adults, youth, and children. In our child and student spaces we will point young people to Christ and help them grow in their faith, and these are the future leaders of our church and our community. Our church will serve countless individuals and change lives over the years.



# RISK

Courageously

*For God has not given us a spirit of timidity,  
but one of power, love and self-discipline.*

**2 TIMOTHY 1:7**

We have a big, bold courageous risk in front of us. \$2.5 million is a large number and it is more than we have ever raised. But that is exciting! If it were easy then we might take the credit. If it's a God sized number then God gets the credit!

We are creating space to do more ministry. We are creating space to do better ministry. We are creating space to have more kids at VBS. We are creating an appealing atmosphere for middle school and high school students so that we can influence future generations for Christ.

Our success will not depend on fancy marketing techniques. Our success will not depend on Pastoral speaking ability or the talent of individuals who attend Grace Community Fellowship. Success depends on our big God.

# EQUIP

Deliberately

*So Christ Himself gave the apostles,  
the prophets, the evangelists, the pastors  
and teachers, to equip His people for  
works of service, so that the body of Christ  
may be built up until we all reach unity in  
the faith and in the knowledge of the Son of  
God and become mature, attaining to the  
whole measure of the fullness of Christ.*

**EPHESIANS 4:11-13**

We want to see more lives changed, more leaders developed across the board from first graders to AARP members. Expanded and well-planned space will give us more tools to minister to more people.

The *Generations Initiative* is about equipping. We are taking a courageous risk by developing facilities to reach and equip this generation and the ones that follow to love more people and help them follow Jesus.

# PROPOSED CONCEPTUAL DRAWINGS

All drawings are conceptual and are likely to change prior to construction.



EXTERIOR (CONCEPTUAL)



EXTERIOR PLAY AREA (CONCEPTUAL)



EXTERIOR PLAY AREA (CONCEPTUAL)

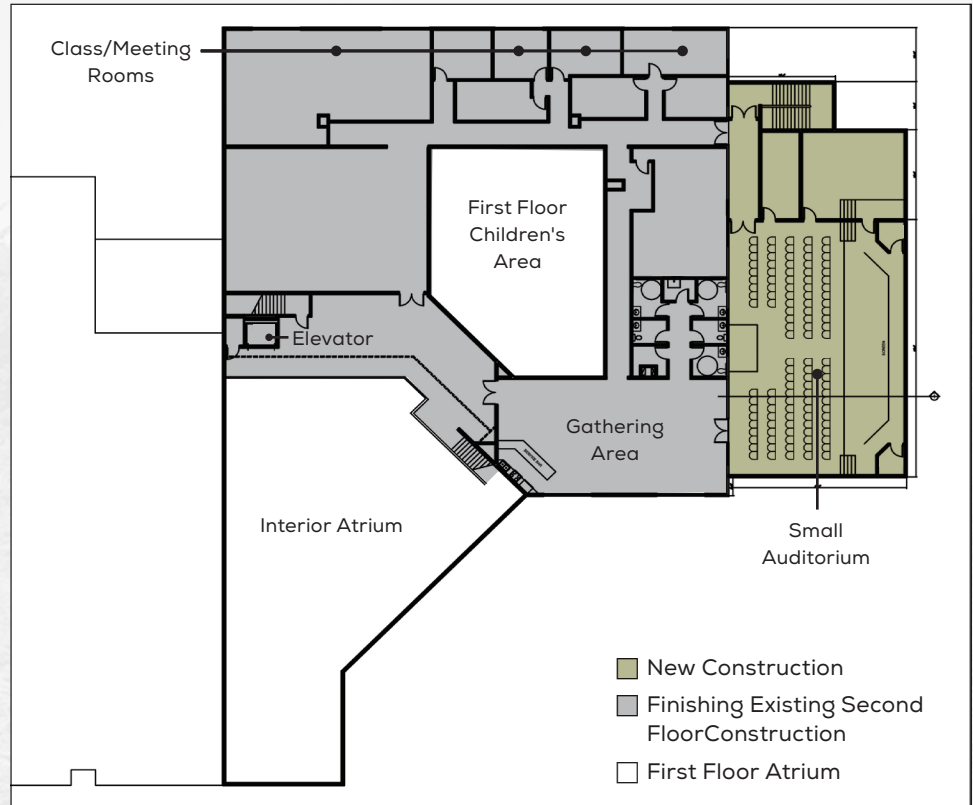

PROPOSED FLOOR PLAN





INTERIOR ATRIUM (CONCEPTUAL)



UPSTAIRS CLASS/MEETING ROOM (CONCEPTUAL)



GATHERING AREA (CONCEPTUAL)



SMALL AUDITORIUM (CONCEPTUAL)

*“Our 12-year-old grandson has emerged as a leader in his Young Life middle school group—and a part of that has been the foundation of faith that GCF has provided in its youth ministry. Praise God!”*

*—BW—*

## THREE-YEAR GIVING CHART

As you prayerfully consider the leading of God’s Spirit in making your Commitment, this chart will assist you by demonstrating how your contributions may be planned in order to yield the desired amount. May your heart, mind, and spirit be tuned to the leading of His Spirit in this decision.

Weekly Total	Monthly	Quarterly	One Year	36 Months
\$5	\$21.67	\$65	\$260	\$780
\$10	\$43.33	\$130	\$520	\$1,560
\$15	\$65.00	\$195	\$780	\$2,340
\$20	\$86.67	\$260	\$1,040	\$3,120
\$25	\$108.33	\$325	\$1,300	\$3,900
\$30	\$130.00	\$390	\$1,560	\$4,680
\$40	\$173.33	\$520	\$2,080	\$6,240
\$50	\$216.67	\$650	\$2,600	\$7,800
\$60	\$260.00	\$780	\$3,120	\$9,360
\$75	\$325.00	\$975	\$3,900	\$11,700
\$100	\$433.33	\$1,300	\$5,200	\$15,600
\$200	\$866.67	\$2,600	\$10,400	\$31,200
\$300	\$1,300.00	\$3,900	\$15,600	\$46,800
\$400	\$1,733.33	\$5,200	\$20,800	\$62,400
\$500	\$2,166.67	\$6,500	\$26,000	\$78,000

# CREATIVE BUDGETING IDEAS...

## Reorganize Your Budget:

- Eliminate eating out one time each week \$30 = \$3,120 for 104 weeks
- Cut back on coffee house coffee \$3.50 X 500 days = \$1,750
- Close a storage unit and garage sell items and give the monthly storage unit fee
- Change the deductible on insurance
- Change the cable service and lower the fee
- Change recreational activities—Redbox Movies instead of going to theater

## Postpone Expense:

- Car or recreational vehicle purchase
- Remodeling project
- Change or postpone a vacation or cruise to less expensive alternatives for two years
- The purchase of clothing or jewelry
- The purchase of furniture
- If someone offers to pay for a meal, activity, etc. which you had planned to pay for, put those funds into *Generations*

## Redirect Current:

- Give money that was spent on tuition to the *Generations* Initiative after private school or college graduation
- Funds used in current sports activities—attending college or professional games
- Once you have paid off credit card debt take the payment you were making and continue to give it to *Generations*
- If you pay off your car, take the payments that you were making and give them to *Generations*

## Consider Other Sources of Income:

- Tax refund, bonuses, inheritance, cash gifts, home-based business, overtime pay
- Savings—Insurance cash value—New Life bonds purchased—when they mature give the bond to the church
- Stock/Property Appreciated assets Land/personal property—art, antiques, coins, jewelry, etc. Donate these to the church to sell, so that you don't have to pay Capital Gains Tax
- Give a percentage of wealth, and then determine the method of giving

*“Over the years I’ve had marvelous teachings from the pulpit,  
Women’s Ministries, and Financial Peace University  
that have helped me grow closer to God in a variety of ways; helping me  
to be a better wife, mother, and steward of God’s gifts.” –MH–*

**GCFWEB.ORG/GENERATIONS**

**LEAVING A LEGACY**  
*of Faith* **STARTS RIGHT NOW.**

**GRACE**  
COMMUNITY FELLOWSHIP

989 Country Club Road  
Eugene, Oregon 97401  
541-683-9205